

SCP product data sheet

Description

Dual Seal Membranes is a unique self-swelling self-healing tanking membrane designed for use as a cold applied flexible membrane that provides a barrier to the passage of water in all underground structures. An LG grade is available for reverse tanking and a salt water grade for saline conditions.

Approvals

Dual Seal Membrane is Agrément certified for use as a suitable tanking membrane for all below ground structures.

Application

Dual Seal Membrane is simply laid on a blinding layer in horizontal situations, when being installed vertically it is mechanically fixed to the concrete substrate. There is no need for primers and the membrane may be installed directly onto green concrete or in damp conditions. Bitusheet overband tape is used to seal lap joints to the membrane.

- Total Membrane Thickness 4mm
- Supply 1.22 metre x 7.32 metre Rolls
- HDPE Thickness 0.375mm
- Roll Width 1.22m
- Roll Length 7.32m
- Roll Weight 41kgs
- Coverage area per Roll 8.59m²
(Subject to standard overlaps)

Dual Seal Membrane

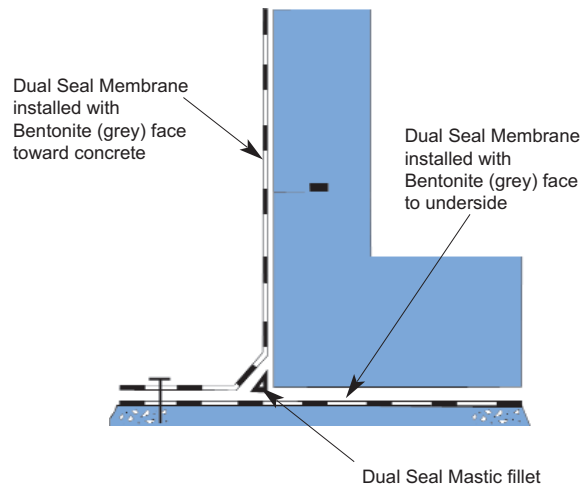

Please contact our Technical department should you require further information or project specific application details



Physical Properties	Value	Test Method
Tensile Strength	27.50 N/mm ²	ASTM D412
% Elongation at Break	700%	D638 Type 4
Puncture Resistance	43 Kg	FTMS 101B
Resistance to Hydrostatic Head	46m	ASTM D751 Method A
Resistance to micro organisms	Unaffected	

SCP CONCRETE SEALING TECHNOLOGY LTD

Crowbush Farm Business Park, Luton Road, Toddington, Beds LU5 6HU United Kingdom

Telephone: +44(0)1525 872700.

Facsimile: +44(0) 1525 871019

Email: info@scpwaterproofing.com

Web: scpwaterproofing.com

Dual Seal Membrane Accessories

Description

To complement the Dual Seal waterproofing system, SCP provide the following accessories to be used in conjunction with Dual Seal Membrane. Please contact our technical sales office for further information regarding their use and application.

Dual Seal Mastic

A troweled mastic comprising of a special formulation of expandable minerals and elastomeric compound which expands and stiffens in the presence of water to form an impervious barrier to water penetration. Used for filling voids, tie holes and honeycombing. May be used to form a 45° fillet at transitions.

Dual Seal Mastic

Supplied	19 Litre Pails
Material	Expandable minerals and compounds
Colour	Grey/Black
Water Migration Resistance	100%
Coefficient of Permeability	10 x 10 ⁻¹⁰
Specific Gravity	1.2

Dual Seal Bentonite Granules

Dual Seal Bentonite Granules are a premium grade high swelling bentonite granule that reacts in the presence of water to form an impervious waterproof gel. Used for forming 40mm x 40mm fillets at all horizontal and vertical transitions.

Dual Seal Bentonite Granules

Supplied	22.7kg Bags
Material	Sodium Bentonite Granules
Colour	Grey
Density	960 kgm ³
Coefficient of Permeability	10 x 10 ⁻¹⁰
Specific Gravity	1.2

Bitusheet XL Tape

Bitusheet XL Self Adhesive Reinforcing Tape comprises of a cross laminated high density polyethylene sheet coated with a bitumen polymer adhesive and is faced with a release sheet. Used as an overband tape for sealing lap joints to Dual Seal Membrane.

Bitusheet XL Tape

Material	Bitumen Polymer Adhesive
Colour	Black
Roll Length	20 metres
Roll Widths	100mm, 150mm, 300mm

Preformed Corners and Top Hats

Manufactured from a high performance polymeric material. SCP provide a range of preformed corners and Top Hats to suit junctions and pipe penetrations which are easily sealed to the Dual Seal Membrane System using Bitusheet Double Sided Tape.

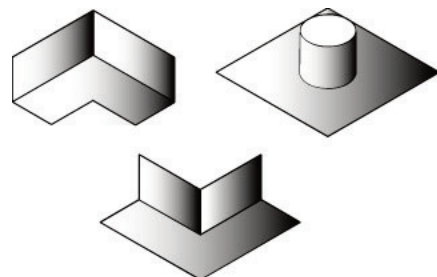

Dual Seal Membrane Application Details

Description

Dual Seal Membranes is a unique self-swelling self-healing tanking membrane designed for use as a cold applied flexible membrane that provides a barrier to the passage of water in all underground structures.

